

Designed by GamFratesi

PRODUCT



COLOURS



Notice: The TS lounge table X-large is not available in brass frame

Item no
Table top: 10022GP-Ø105
Frame: 10022ST-Ø105, 10022STM-Ø105
+ style code

DESCRIPTION

TS Table is designed by GamFratesi. TS table work together as a small group, complementing each other with its different sizes and heights, but they also work equally well as singles. TS Table is available in four sizes, with a marble/glass table top, black lacquered/brass frame.

VERSION

Graphite Black - glass top / RAL 9011 // black lacquered frame / RAL 9005 gloss 15
Grey Blue / RAL 5008 // black lacquered frame / RAL 9005 gloss 15
Vintage Red / RAL 3012 // black lacquered frame / RAL 9005 gloss 15
Dusty Green / RAL 160 50 20 // black lacquered frame / RAL 9005 gloss 15
Rusty Red / RAL 030 30 // black lacquered frame / RAL 9005 gloss 15
Oyster White / RAL 1013 // black lacquered frame / RAL 9005 gloss 15

TYPES

Order item - look for part number in the pricelist.
The series consists of the following:

TS TABLE Ø40, TS TABLE Ø55, TS TABLE Ø80, TS TABLE Ø105, TS TABLE ROUND CONSOLE Ø40



MEASUREMENTS

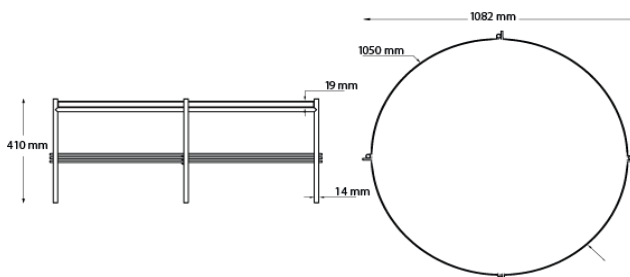

FACTS

MEASUREMENT
Height: 410 mm
Width: 1082 mm
Table top diameter: 1050 mm
Table top thickness: 19 mm
Leg diameter: 14 mm

WEIGHT ITEM
Ø105: Table top 40,4 kg, Frame 5,5 kg

PACKAGING TYPE
Cardboard box, Chipboard, Foam

PACKAGING MEASUREMENT Ø105- L X W X H CM
Table top: L: 115 X W: 115 X H: 6,5 CM
Frame: L: 82 X W: 82 X H: 44 CM

WEIGHT PACKAGING - MATERIAL TYPE
Ø105 Table top:
- Delivery note: 5 g
- Chipboard: 24700 g
- Foam protector: 30 g
- Strapping: 10 g
Total: 24,745 kg

Ø105 Table frame:
- Delivery note: 5 g
- Cardboard: 1400 g
- Foam protector: 50 g
Total: 1,455 kg

WEIGHT TOTAL:
72,1 kg

NUMBER OF PARCELS
2 psc.

CLEANING AND MAINTENANCE

For dusting and light cleaning of the frame use a soft, dry cloth.

For further cleaning of the frame, use a soft cloth that is firmly wrung in clean water for gently wiping the surface, and then immediately use a dry cloth to wipe the surface again.

If more thorough cleaning is necessary, use a mild detergent or washing-up liquid dissolved in water on a firmly wrung cloth to wipe the seat. Afterwards, repeat the process with clean water as described above. For Cleaning of the marble top use a soft cloth firmly wrung in water mixed with soap flakes. Scrub the surface into the soapy water, leave it for 5-10 min and then rinse in clean cold water.

Polish with a soft cloth after wiping.

Do not use materials for maintenance that:

- Contain abrasive agents.
- Are basic, acidiferous or organic.

For the best maintenance of the product, protect it against sunlight and heat, and try to keep it away from moisture, grease and other dirt.

Furthermore, protect the surfaces against sharp objects and other that might scratch.

ENVIRONMENT

Parts can be separated and sorted for recycling.

TESTS

-

CERTIFICATION AND LABELS

-

Designed by GamFratesi

PRODUCT



COLOURS



Notice: The TS lounge table X-large is not available in brass frame

DESCRIPTION

TS Table is designed by GamFratesi. TS table work together as a small group, complementing each other with its different sizes and heights, but they also work equally well as singles. TS Table is available in four sizes, with a marble/glass table top, black lacquered/brass frame.

VERSION

Bianco Carrara - white marble top // black lacquered frame / RAL 9005 gloss 15
 Nero Marquina - black marble top // black lacquered frame / RAL 9005 gloss 15
 Verde Guatemala - green marble top // black lacquered frame / RAL 9005 gloss 15

TYPES

Order item - look for part number in the pricelist.
 The series consists of the following:

TS TABLE Ø40, TS TABLE Ø55, TS TABLE Ø80, TS TABLE Ø105, TS TABLE ROUND CONSOLE Ø40, TS TABLE 2 CONSOLE, TS TABLE 1 CONSOLE.



MEASUREMENTS

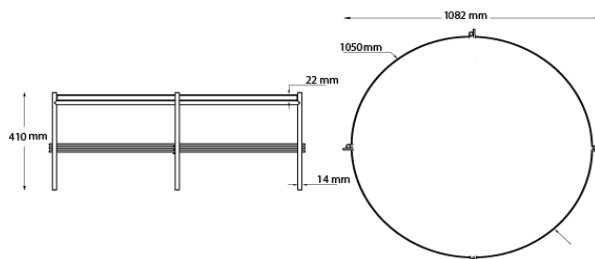

FACTS

MEASUREMENT

Height: 410 mm
 Width: 1082 mm
 Table top diameter: 1050 mm
 Table top thickness: 20 mm
 Leg diameter: 14 mm

WEIGHT ITEM

Ø105: Table top 51,3 kg, Frame 5,5 kg

PACKAGING TYPE

Cardboard box, Chipboard, Foam

PACKAGING MEASUREMENT Ø105- L X W X H CM

Table top: L: 115 X W: 115 X H: 6,5 CM
 Frame: L: 82 X W: 82 X H: 44 CM

WEIGHT PACKAGING - MATERIAL TYPE

Ø105 Table top:
 - Delivery note: 5 g
 - Chipboard: 24700 g
 - Foam protector: 30 g
 - Strapping: 10 g
 Total: 24,745 kg

Ø105 Table frame:

- Delivery note: 5 g
 - Cardboard: 1400 g
 - Foam protector: 50 g
 Total: 1,455 kg

WEIGHT TOTAL:

83 kg

NUMBER OF PARCELS

2 psc.

CLEANING AND MAINTENANCE

Black Lacquered Metal Frame

Daily cleaning is done by wiping the frame with a clean dry cloth, or with a cloth hardly wrung in clean water. Dirty surfaces are cleaned with a hardly wrung cloth out of soapy water or in water with added liquid soap. Wipe after with a clean dry cloth.

Marble Top

For marble maintenance, see the included marble instruction sheet.

ENVIRONMENT

Parts can be separated and sorted for recycling.

TESTS

-

CERTIFICATION AND LABELS

-